

**ORDERING NUMBER**

**MTP - 24HF - 1 - X - X - X**

MTP - 24HF - 1 -	X -	PURITY
		MATERIAL
	X -	NUMBER OF PORTS
		SEAL TYPE
X	BASE SIZE	

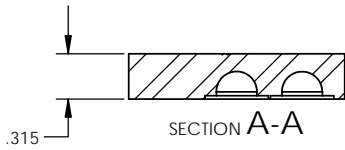

BASE SIZE	SEAL TYPE	NUMBER OF PORTS	ORDERING NUMBER
1.500" HF	C-SEAL	2-PORTS	MTP-24HF-1-2-X-X
		3-PORTS	MTP-24HF-1-3-X-X

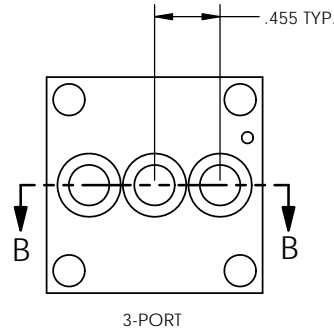
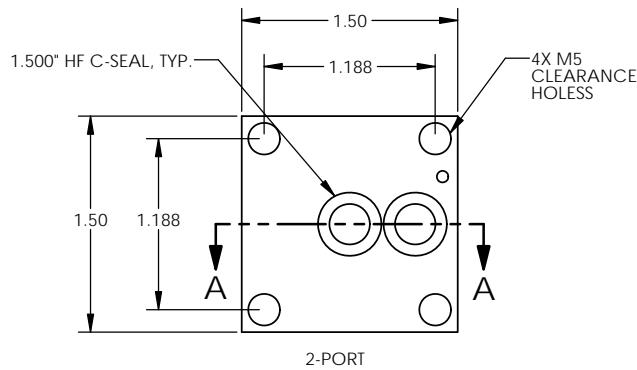

- MATERIAL DESIGNATORS**
- S = 316L SST SEMI F20
  - A = 316L
  - B = 316L SST SEMI F20 VIM/VAR
  - N = NICKEL 200
  - M = NICKEL 400
  - H = NICKEL ALLOY C22

- PURITY DESIGNATORS**
- S = STANDARD FINISH
  - H = HIGH PURITY
  - U = ULTRA-HIGH PURITY

**NOTES:**  
 1. DRAWINGS FOR SPECIFICATION PURPOSES AND ARE FOR REFERENCE ONLY.  
 2. ALL VERSIONS OF THE DRAWING ARE SUPERSEDED BY THIS RELEASE AND SUBJECT TO CHANGE WITHOUT NOTIFICATION.

EFFECTIVE DATE: 10/16/2017	 1003 INDUSTRIAL DRIVE SAUK RAPIDS, MN 56379 VOICE: 320-251-0390 FAX: 320-251-5810
INTERPRET DRAWING PER: ASME Y14.5 - 2009	
THIRD ANGLE PROJECTION:	
PROPRIETARY AND CONFIDENTIAL THE INFORMATION CONTAINED IN THIS DRAWING IS THE SOLE PROPERTY OF TALON INNOVATIONS, INC. ANY REPRODUCTION IN PART OR AS A WHOLE WITHOUT THE WRITTEN PERMISSION OF TALON INNOVATIONS, INC. IS PROHIBITED.	DESCRIPTION: <b>MODULAR TOP PLUG          1.500" HF C-SEAL</b>
DO NOT SCALE DRAWING	SIZE: <b>C</b> SCALE: 3:2 PART NUMBER: <b>MTP-24HF-1-X-X-X</b> SHEET 1 OF 1